

ASSEMBLY INSTRUCTIONS FOR: QUEEN/KING UPHOLSTERED BED

SIGNATURE DESIGN BY **ASHLEY**®

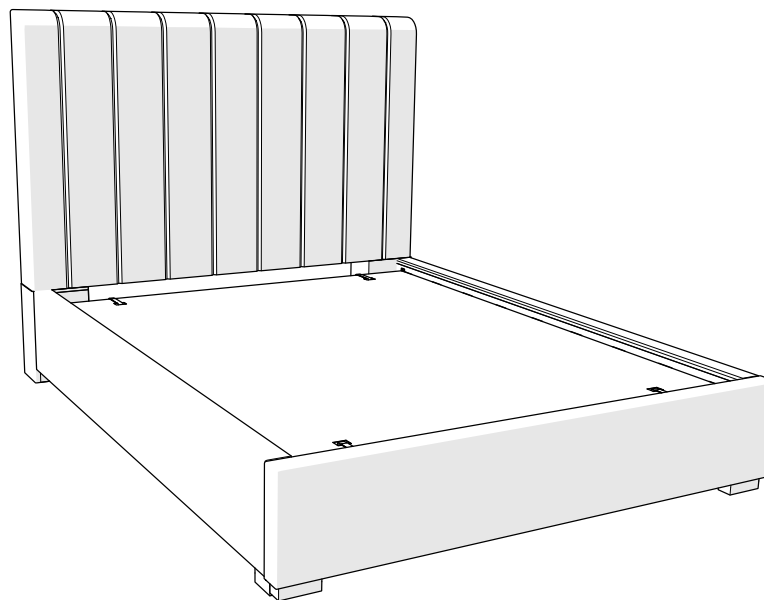

Scan Code for
Video Tutorial

WATCH NOW

Life doesn't come with
instructions, but this does

PART # 10562622 (03/26/26)

HARDWARE

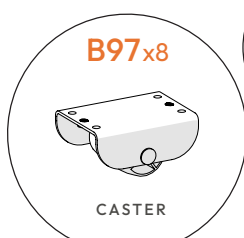

BUST OUT
REQUIRED TOOL



This bag contains small parts that present a choking hazard for children under 3 years of age. These parts are for adult assembly only and should be permanently affixed to the furniture. Any unused parts should be discarded properly.

Esta bolsa contiene piezas pequeñas que presentan un peligro de asfixia. para niños menores de 3 años. Estas piezas son para adultos. montaje solamente y debe fijarse permanentemente a la muebles. Las piezas no utilizadas deben desecharse correctamente.

Ce sac contient de petites pièces qui présentent un risque d'étouffement pour les enfants de moins de 3 ans. Ces pièces sont pour adultes montage uniquement et doit être fixé de façon permanente au meubles. Toutes les pièces inutilisées doivent être jetées correctement.

Deze tas bevat kleine onderdelen die verstikkingsgevaar opleveren voor kinderen onder de 3 jaar. Deze onderdelen zijn voor volwassen montage alleen en moet permanent worden bevestigd aan de meubilair. Alle ongebruikte onderdelen moeten op de juiste manier worden weggegooid.

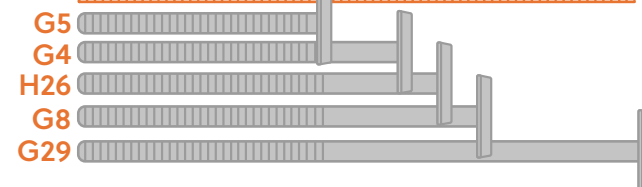
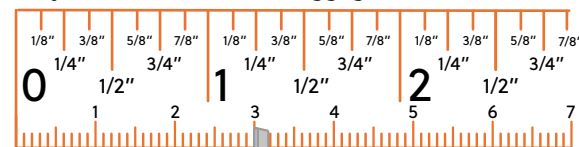
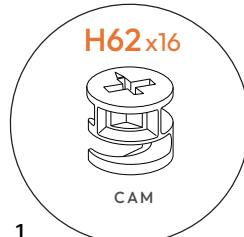
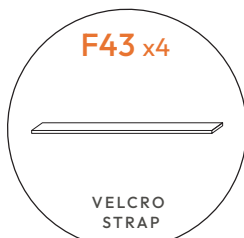
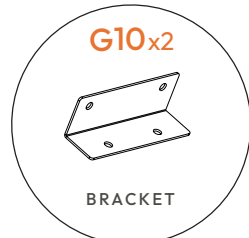

COMPONENTS

- ① FOOTBOARD
- ② FOOTBOARD LEG (2)
- ③ RAIL LEG (2)
- ⑤ RIGHT BED RAIL
- ⑥ LEFT BED RAIL
- ⑦ CENTER SUPPORT (3)
- ⑧ PLATFORM
- ⑩ HEADBOARD
- ⑪ LEFT HEADBOARD LEG
- ⑫ RIGHT HEADBOARD LEG
- ⑱ CASTER BLOCK (8)
- ⑳ SUPPORT BEAM
- ㉕ SPACER BEAM (2)
- ㉖ DRAWER BACK (2)
- ㉗ DRAWER BOTTOM (2)
- ㉘ DRAWER SIDE (4)
- ㉚ DRAWER FRONT (2)

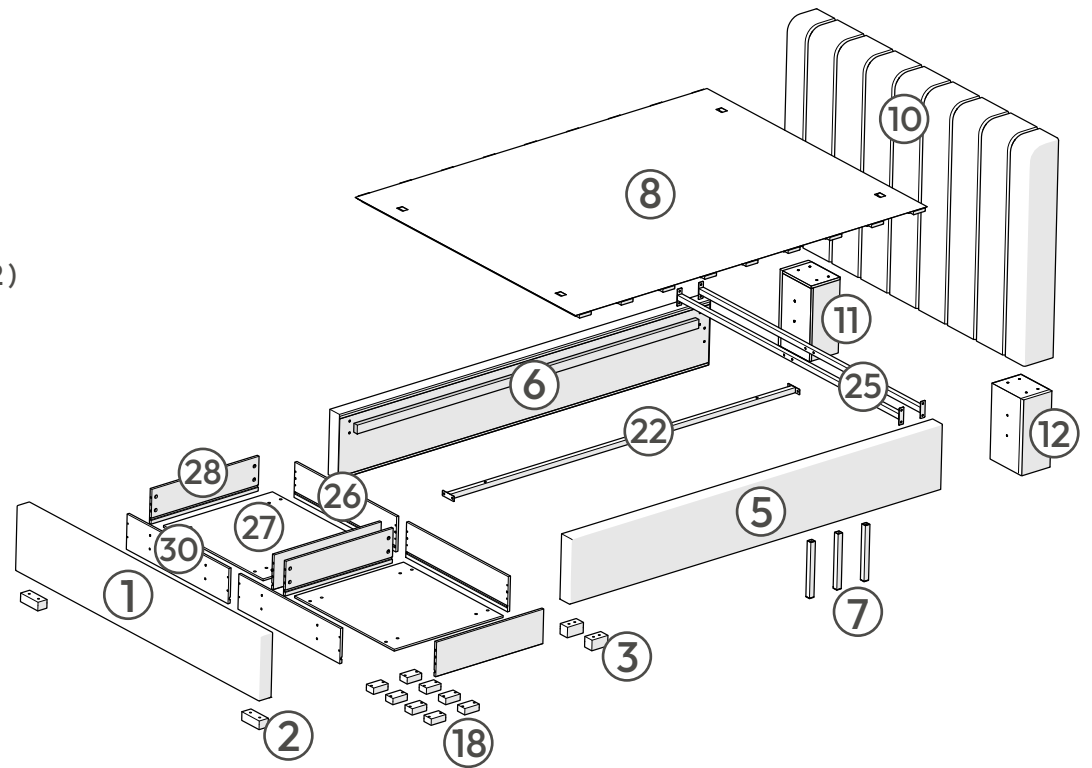

HARDWARE AND COMPONENTS NEEDED ON THIS PAGE:

G4 40 MM JOINT CONT.

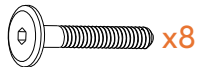

H24 ALLEN WRENCH



- ⑩ HEADBOARD
- ⑪ LEFT HDB LEG
- ⑫ RIGHT HDB LEG

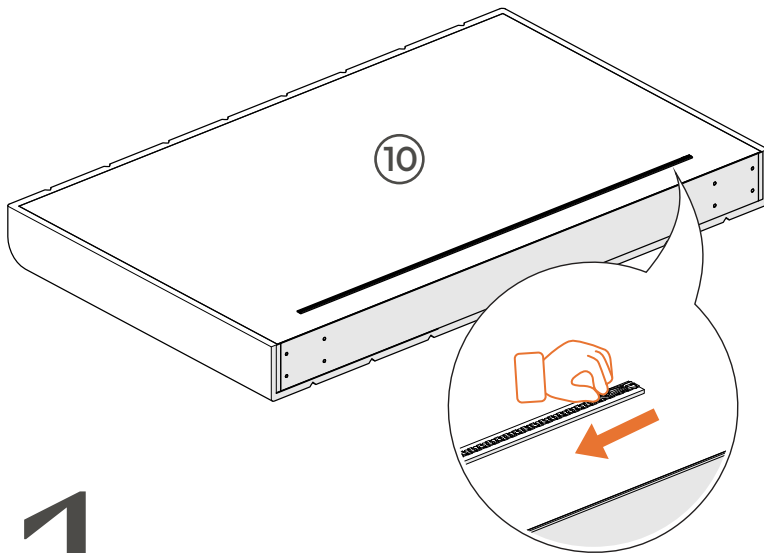

1

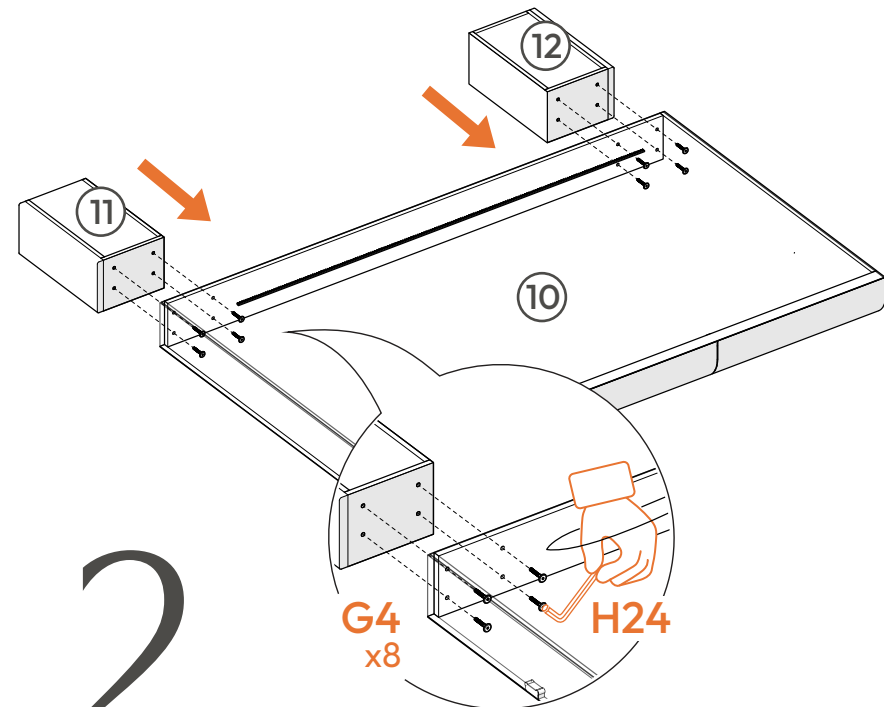

2

HARDWARE AND COMPONENTS NEEDED ON THIS PAGE:

G5 30MM JOINT CONT.

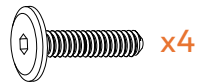

G10 BRACKET

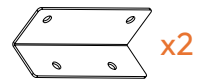

G29 70MM JOINT CONT.

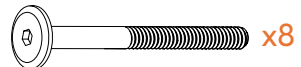

H14 CAM DOWEL

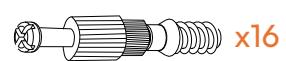

H24 ALLEN WRENCH

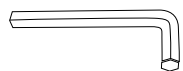

⑥ LEFT BED RAIL

⑤ RIGHT BED RAIL

③ RAIL LEG (2)

② FTBD LEG (2)

① FOOTBOARD

③⑩ DRAWER FRONT (2)

②⑥ DRAWER BACK (2)

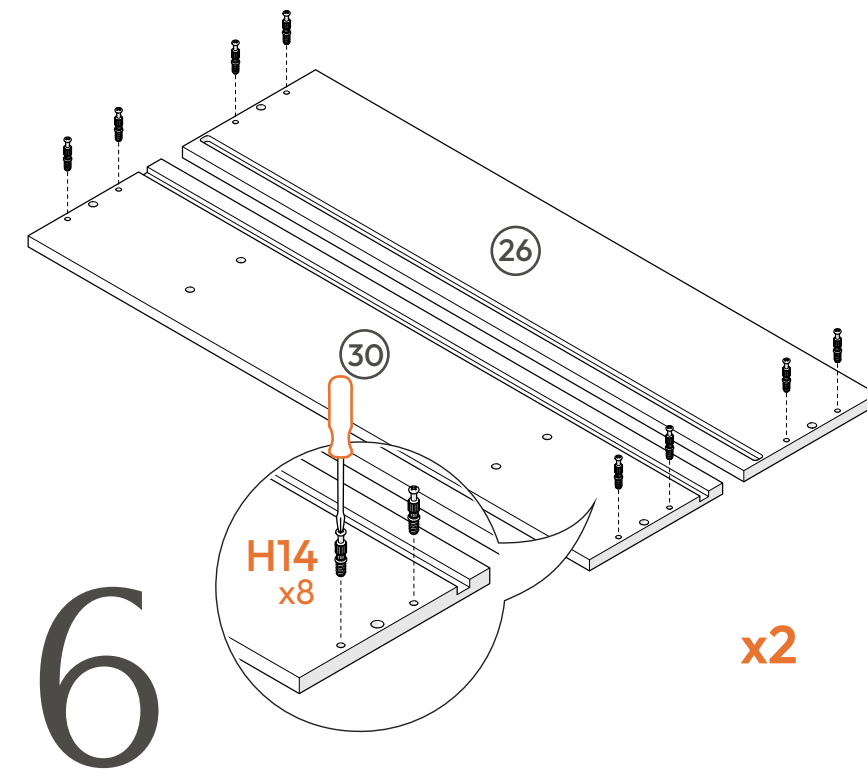
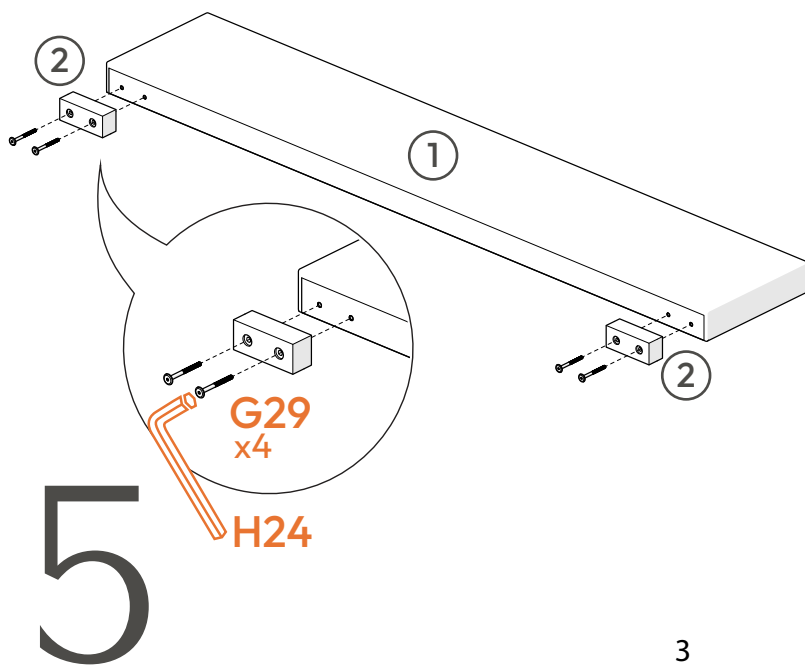
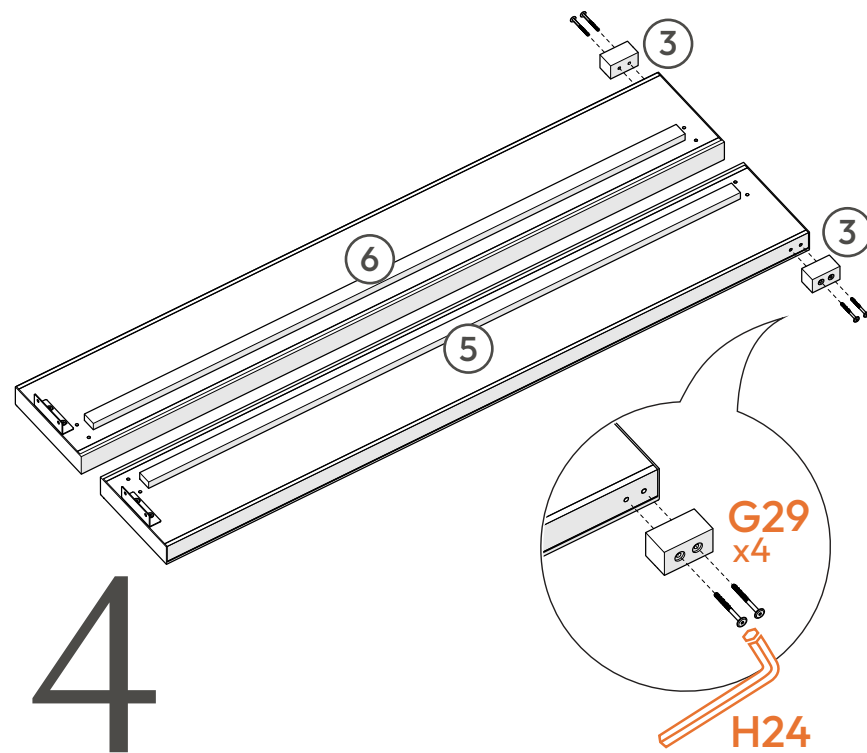
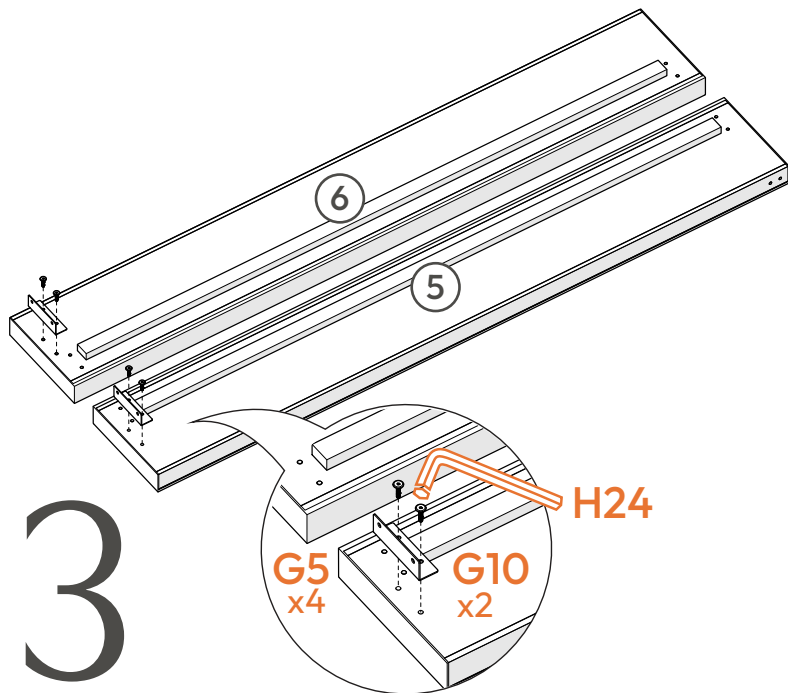

HARDWARE AND COMPONENTS NEEDED ON THIS PAGE:

H56 WOOD DOWEL

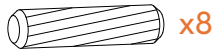

H62 CAM



G8 50MM JOINT CONT.

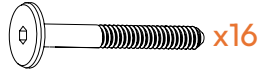

B97 CASTER

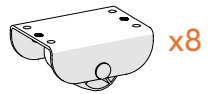

H24 ALLEN WRENCH



(28) DWR SIDE (4)

(30) DWR FRONT (2)

(27) DWR BTM (2)

(26) DWR BACK (2)

(18) CASTER BLOCK (4)

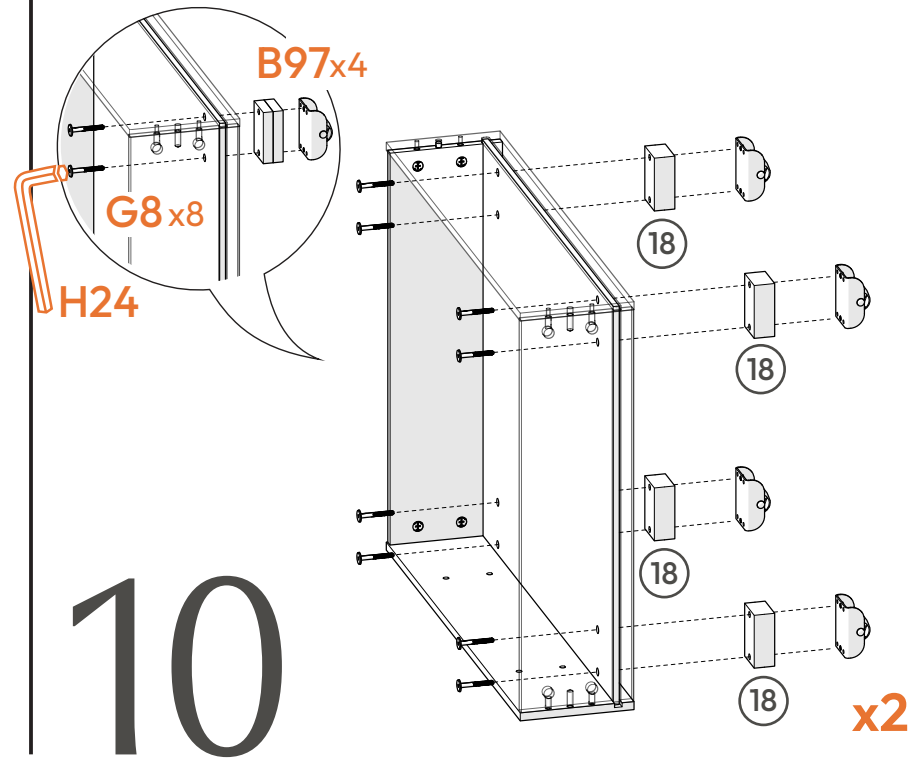
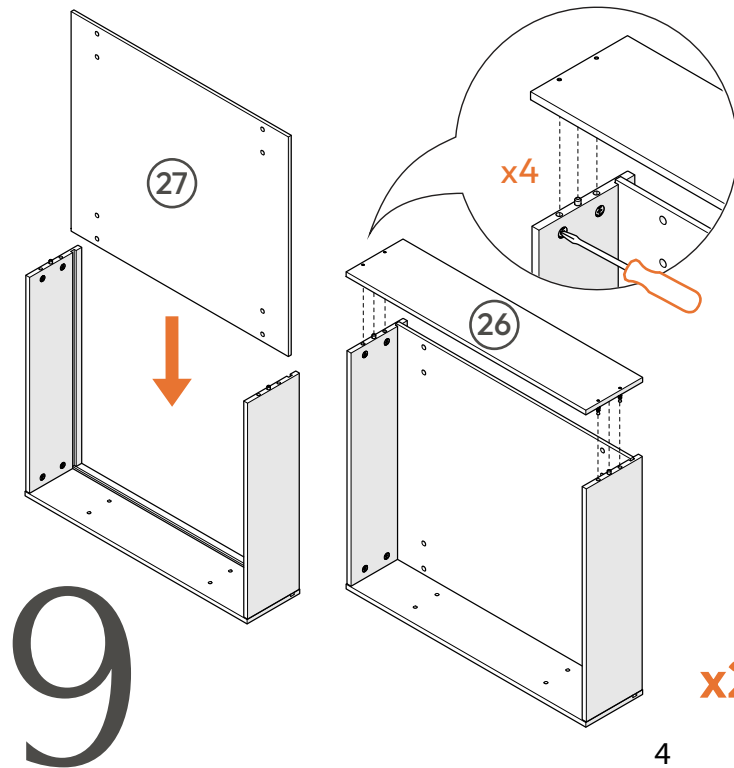
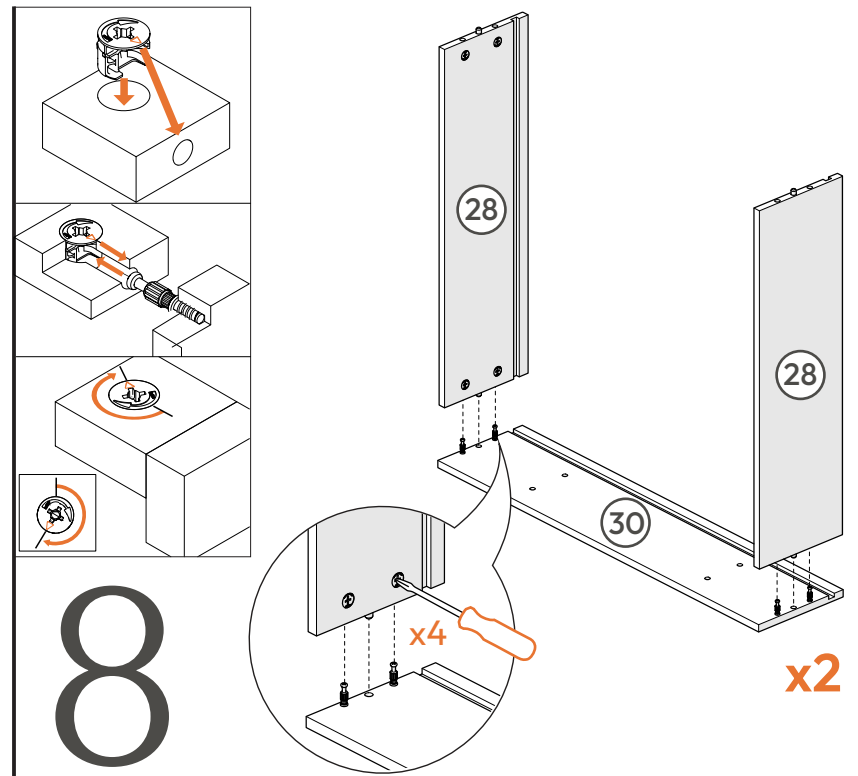
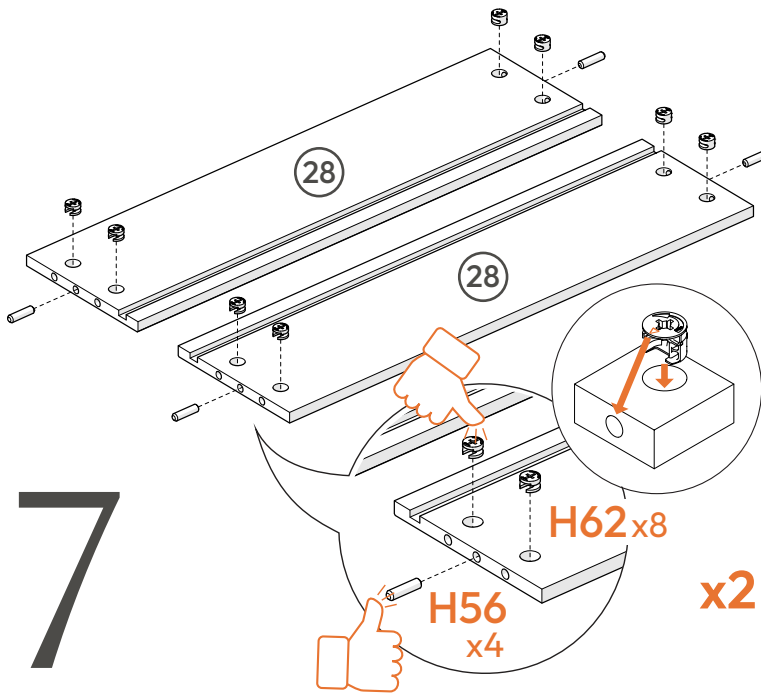

HARDWARE AND COMPONENTS NEEDED ON THIS PAGE:

G5 30MM JOINT CONT.



H26 45MM JOINT CONT.



H24 ALLEN WRENCH



- ① FOOTBOARD
- ⑥ LEFT BED RAIL
- ⑤ RIGHT BED RAIL
- ②⑤ SPACER BEAM
- ②② SUPPORT BEAM
- ⑦ CENTER SUPPORT(3)

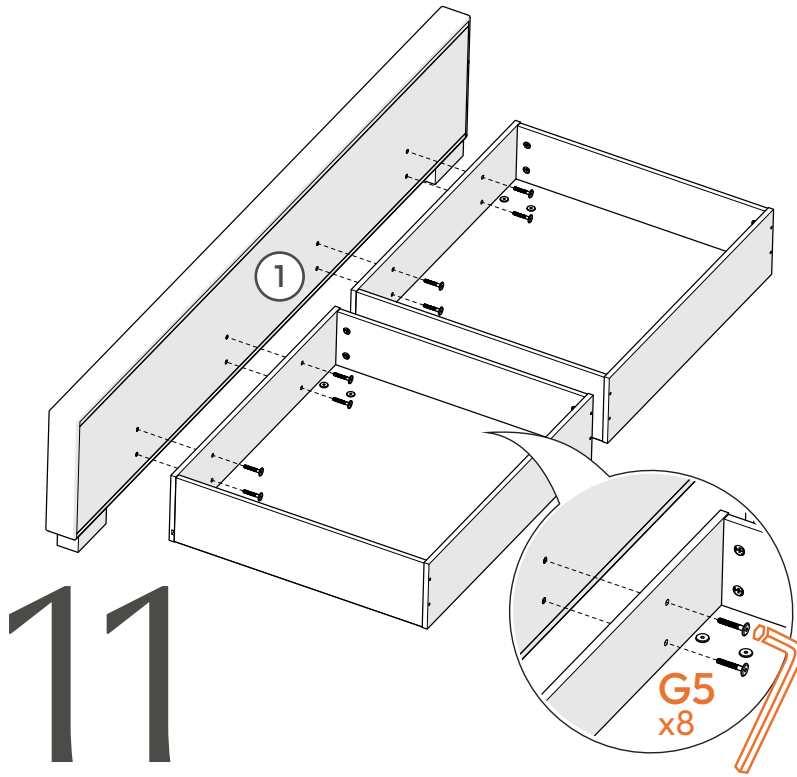

11

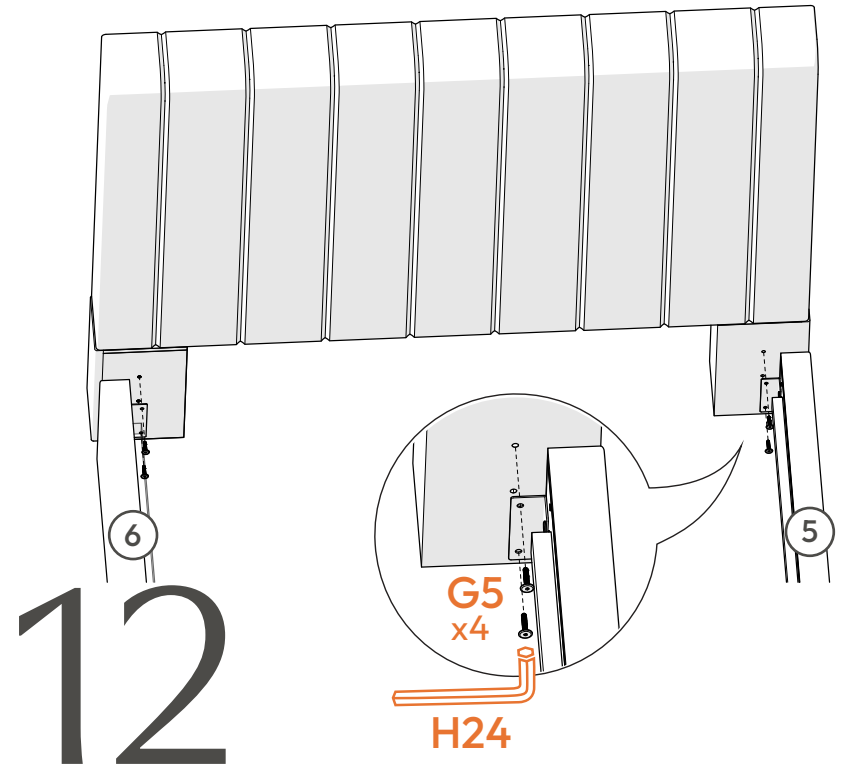

12

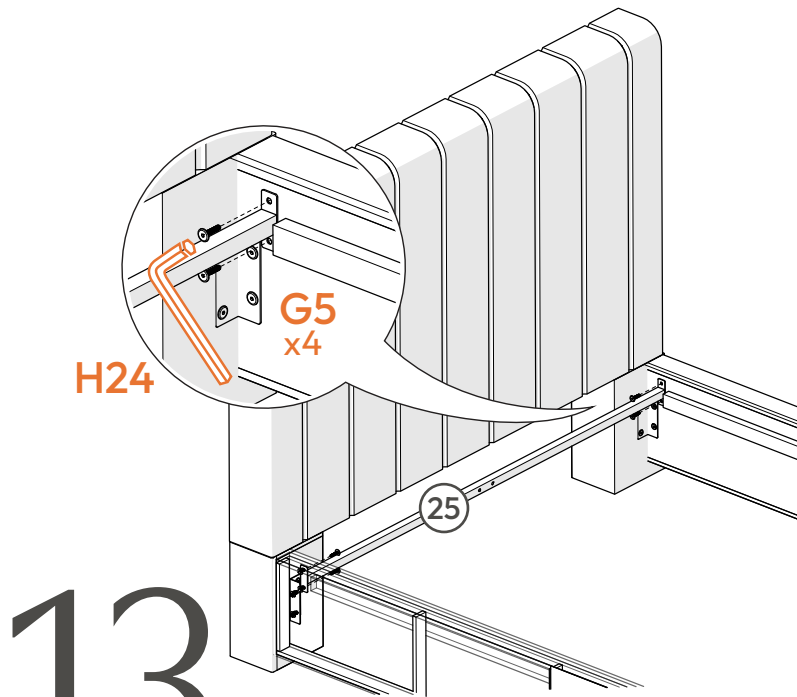

13

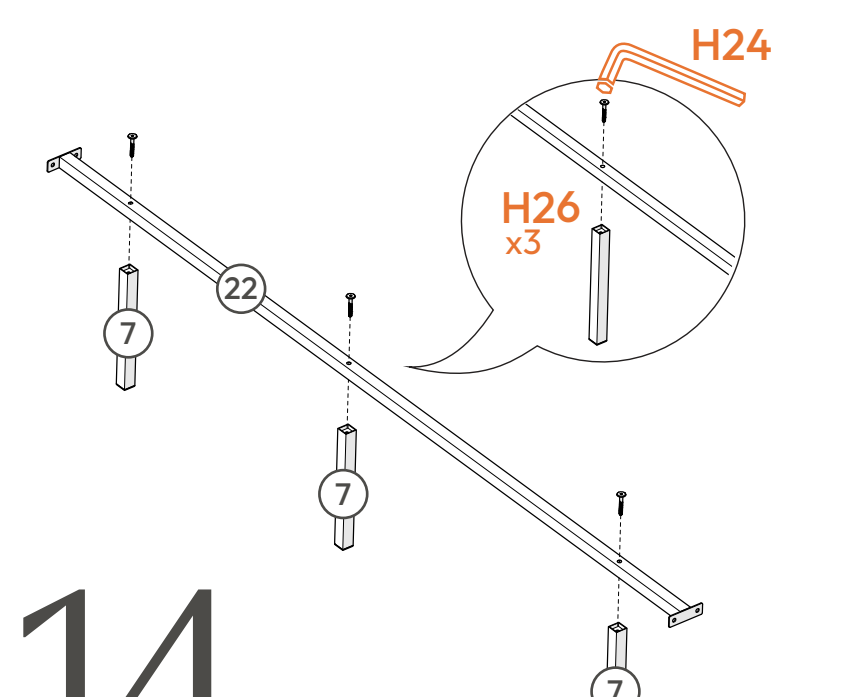

14

HARDWARE AND COMPONENTS NEEDED ON THIS PAGE:

G4 40 MM JOINT CONT. x4

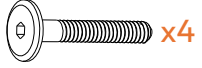

G9 NUT x4



G14 WRENCH



G5 30MM JOINT CONT. x4



F43 VELCRO STRAP x4



25 SPACER BEAM

8 PLATFORM

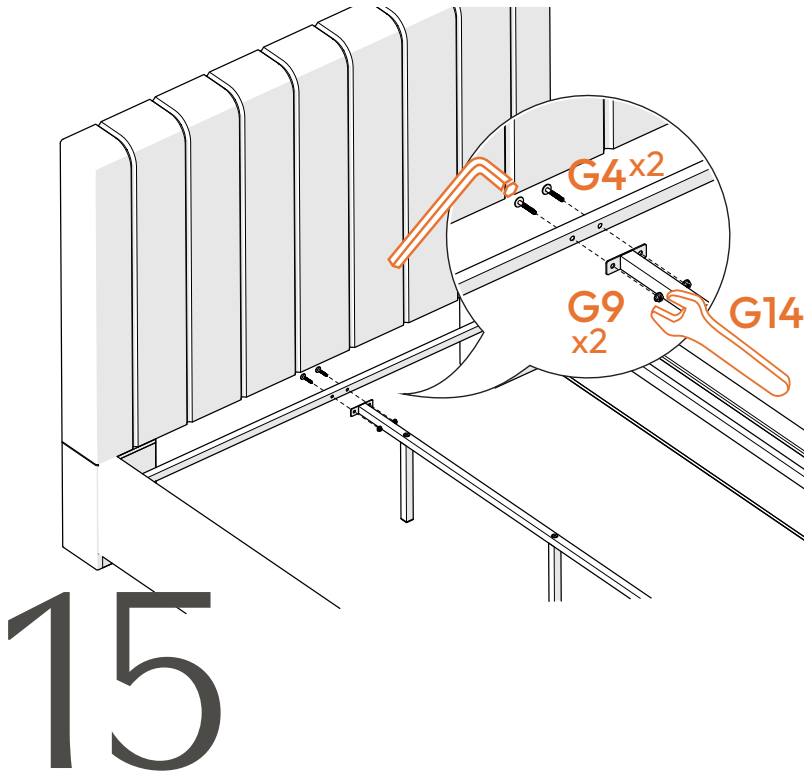

15

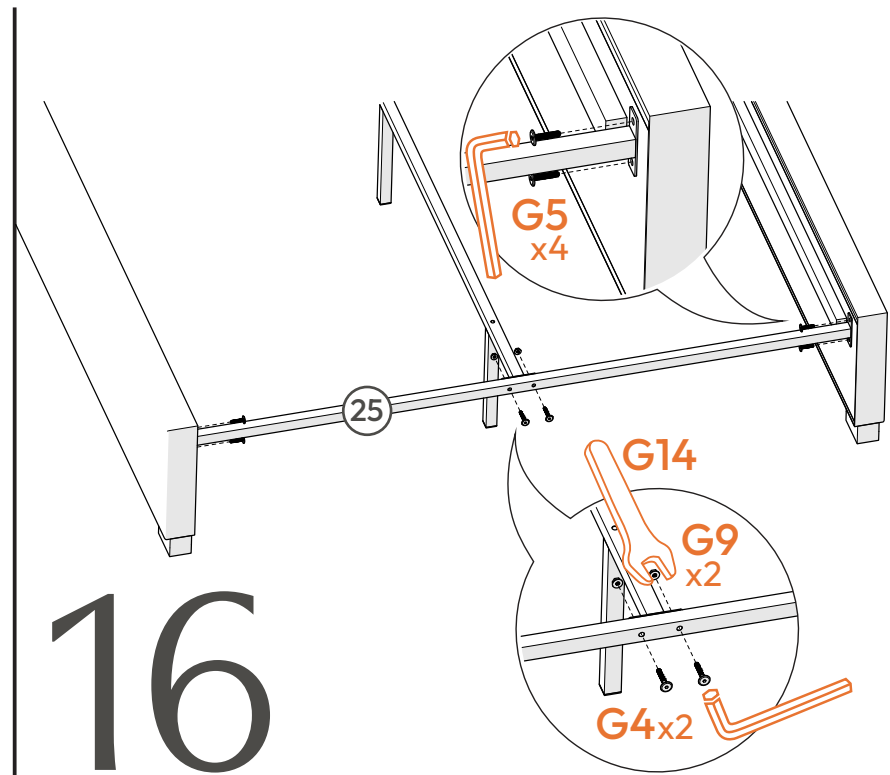

16

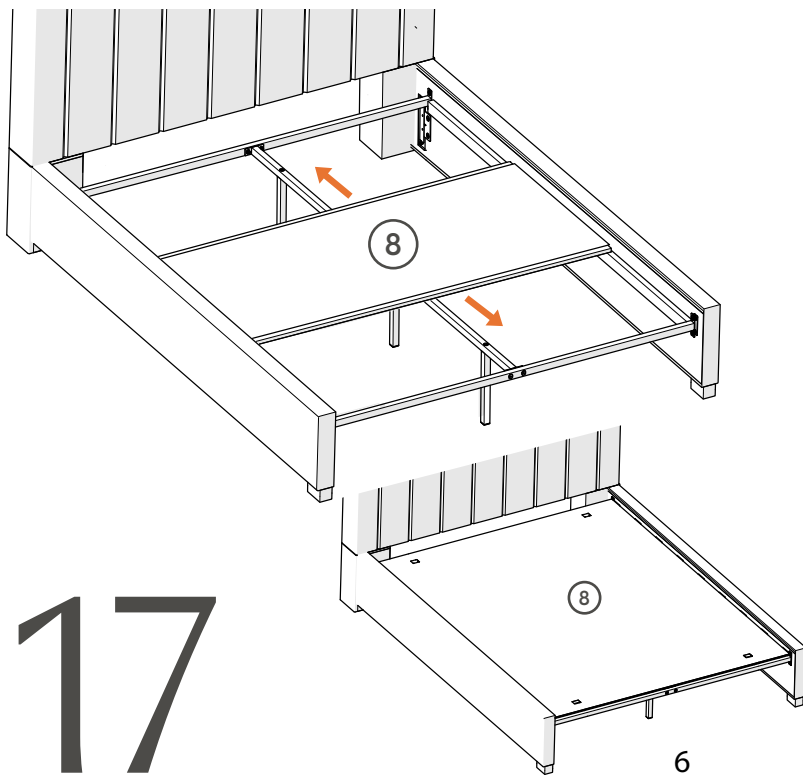

17

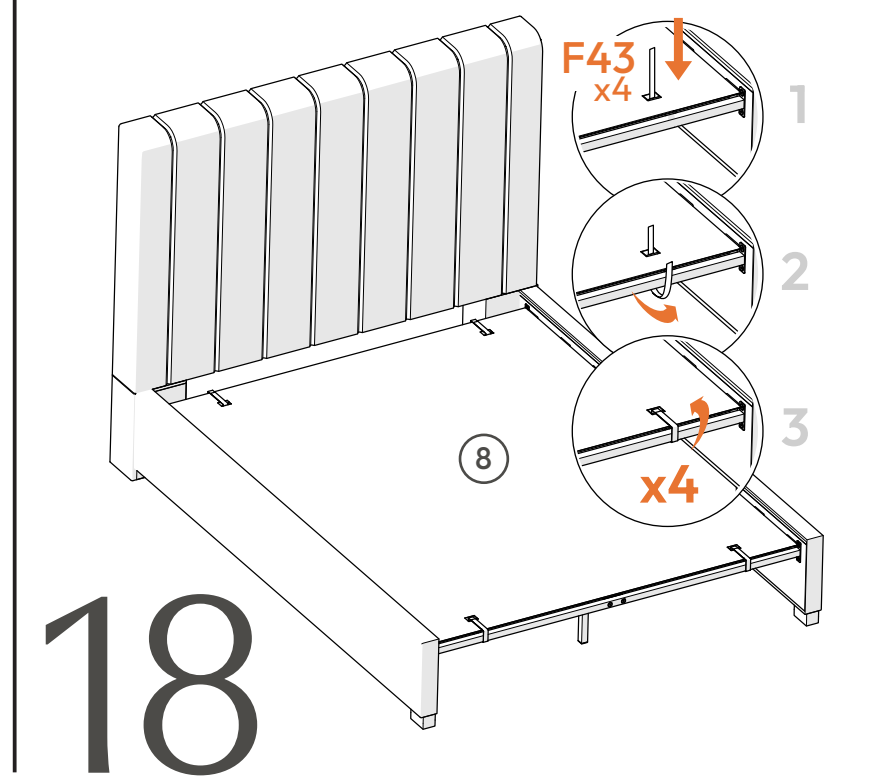

18

HARDWARE AND
COMPONENTS NEEDED
ON THIS PAGE:

G42 SCREW



19

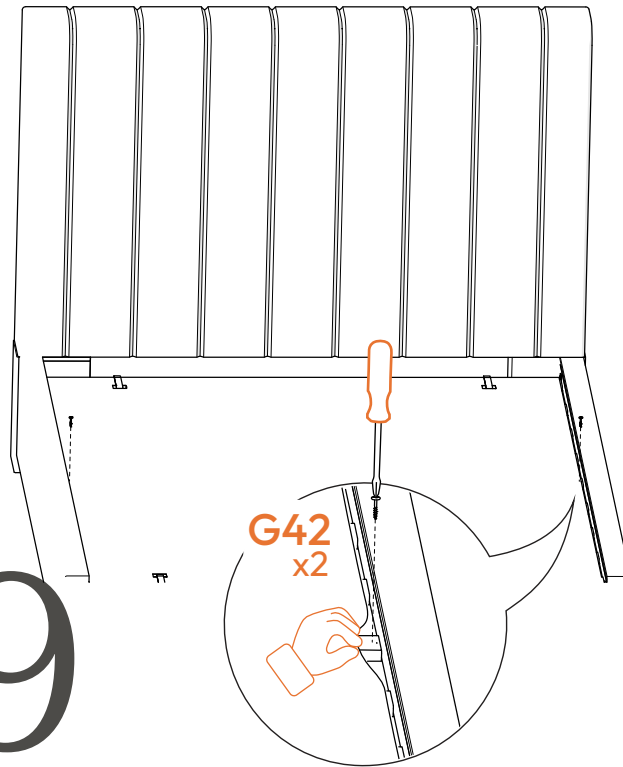

20

